

Specifications: Ø75 LED 500Lm

Model: COE075A

Paint Cone Mini Downlight -Fixed

remark:

LED Lighting

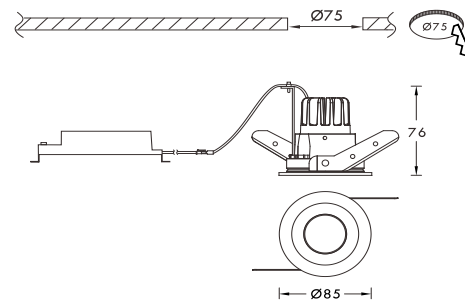

#### ● Specifications ●

Light Source :	Cree COB LED (CMA-1306)
CCT :	2700K / 3000K / 4000K / 5000K (Optional)
CRI :	> 90(Ra)
SDCM :	≤ 3(Step) (±150K)
LED Flux :	761 Lm (±3.5%)
Luminaire Flux :	500 Lm (Use 24° as standard)
Beam Angle :	18°(2890cd) 24°(1870cd) 38°(973cd) 62°(684cd)
LED Power :	7.2W / 200mA
Consumption :	9.4W
In ambient temperature 25°C, only for use at ambient temperatures below 45°C.	
Input Voltage :	100-240V (50~60Hz)
Driver :	2-Stage, Active-PFC(<20W PF>0.9 , >20W PF>0.95 ) THD<15%, Overload Protection Power conversion efficiency 80~90% (>European ErP standard) *Proportional to system watt.
Flicker :	Flicker Index ≤0.01, Percent Flicker ≤1% (CIETN006:2016)

#### ● Light Distribution ●

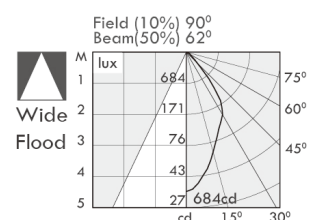
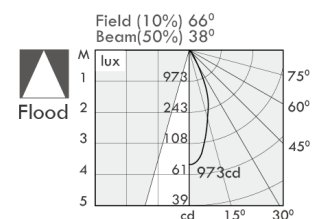
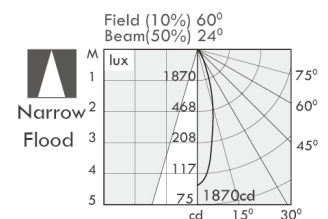
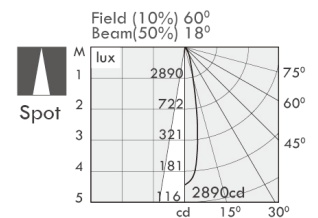

#### ● Safety ●

UGR :	< 19
Ingress Protection:	IP20
Heat sink :	Changeable Die-cast Module
Dimming interface :	DC 0~10V / DALI / PWM / Sub-G(wireless) / Triac (Optional)
Safety Certification :	CNS-14115 、CNS-14335 、CNS-15592 、CE 、CB

#### ● Lifetime ●

Lumen maintenance L90 > 36K Hrs., L70 > 100 K Hrs.( L90/B10 36,000Hrs ).
In ambient temperature-20°C ~45°C (LED manufacturer specifications)
Driver lifetime > 50K Hrs.

#### ● Description ●

Die-cast aluminum heat sink with electro-deposition coating.
Fireproof PC optical lens.
Die-cast aluminum lamp body with liquid painting.
Steel ring with electro-deposit (ED) coating and stainless steel spring clip.
Japanese standard quick plug terminal (applicable to solid conductor cable Ø1.6~2.0mm),
Anti-pull and avoid bad connection.
Modular and quick plug cable design design is easy to install and maintain.

